

# Two Hole Pipe Straps

TYPE 304 and 316 Stainless Steel

## DIMENSIONS (INCHES)

CATALOG NO.	PIPE SIZE	A	B	C	HOLE SIZE	STOCK SIZE	LOAD RATING LBS.	APPRX WEIGHT PER 100
50B08-SS	1/2	4-1/8	7/16	2-7/8	7/16	1/8 X 1-1/4	410	21
50B09-SS	3/4	4-5/16	9/16	3-1/16	7/16	1/8 X 1-1/4	410	24
50B10-SS	1	4-9/16	11/16	3-5/16	7/16	1/8 X 1-1/4	410	26
50B11-SS	1-1/4	4-15/16	13/16	3-11/16	7/16	1/8 X 1-1/4	410	30
50B12-SS	1-1/2	5-3/16	15/16	3-15/16	7/16	1/8 X 1-1/4	410	33
50B14-SS	2	5-3/4	1-1/8	4-1/2	7/16	1/8 X 1-1/4	410	38
50B16-SS	2-1/2	6-1/4	1-3/8	5	7/16	1/4 X 1-1/4	610	85
50B18-SS	3	6-7/8	1-3/4	5-5/8	7/16	1/4 X 1-1/4	610	100
50B19-SS	3-1/2	7-3/8	2	6-1/8	7/16	1/4 X 1-1/4	610	111
50B22-SS	4	8-3/8	2-1/4	7-1/8	9/16	1/4 X 1-1/2	725	151
50B26-SS	5	9-7/16	2-3/4	8-3/16	9/16	1/4 X 1-1/2	725	179
50B30-SS	6	10-1/2	3-5/16	9-1/4	9/16	1/4 X 1-1/2	725	207
50B32-SS	8	14	4-5/16	12	11/16	3/8 X 1-1/2	900	415

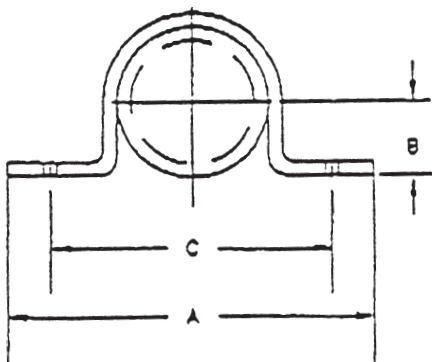

MATERIAL:  
TYPE 304 or TYPE 316 STAINLESS STEEL  
WHEN ORDERING:  
SPECIFY NAME, NUMBER, PIPE SIZE AND MATERIAL.